

Service  
Service  
Service



Philips Consumer Lifestyle

# Service Manual

## PRODUCT INFORMATION

- This product meets the requirements regarding interference suppression on radio and TV.
- After the product has been repaired, it should function properly and has to meet the safety requirements as officially laid down at this moment.

## DISASSEMBLY- AND RE-ASSEMBLY ADVICE

- No specific issues

## REPAIR INSTRUCTIONS

- This is a replacement product, only the consumer replaceable parts can be used to service this appliance.

## OPTIONAL (accessories)

- No specific issues

## TECHNICAL INFORMATION

- Voltage : 220 - 240V
- Frequency : 50 / 60 Hz
- Power consumption : 500 - 600 W
- Colour setting : Brushed stainless steel
- Weight : 1,25 Kg
- Dimensions L x W x H (cm)
  - Appliance on base : 12,5 x 18,5 x 21,0
  - F-Box : 16,8 x 22,0 x 16,5
- Length of cord : 0.75 m

## Consumer Replaceable Parts

- Base : CRPxxx
- Lid (incl. motor) : CRPxxx
- Whisking coil : CRPxxx

## Materials

- Jug : Stainless steel
- Inner jug : Stainless steel with non-stick coating
- Lid : Plastic
- Whisking coil : Stainless steel

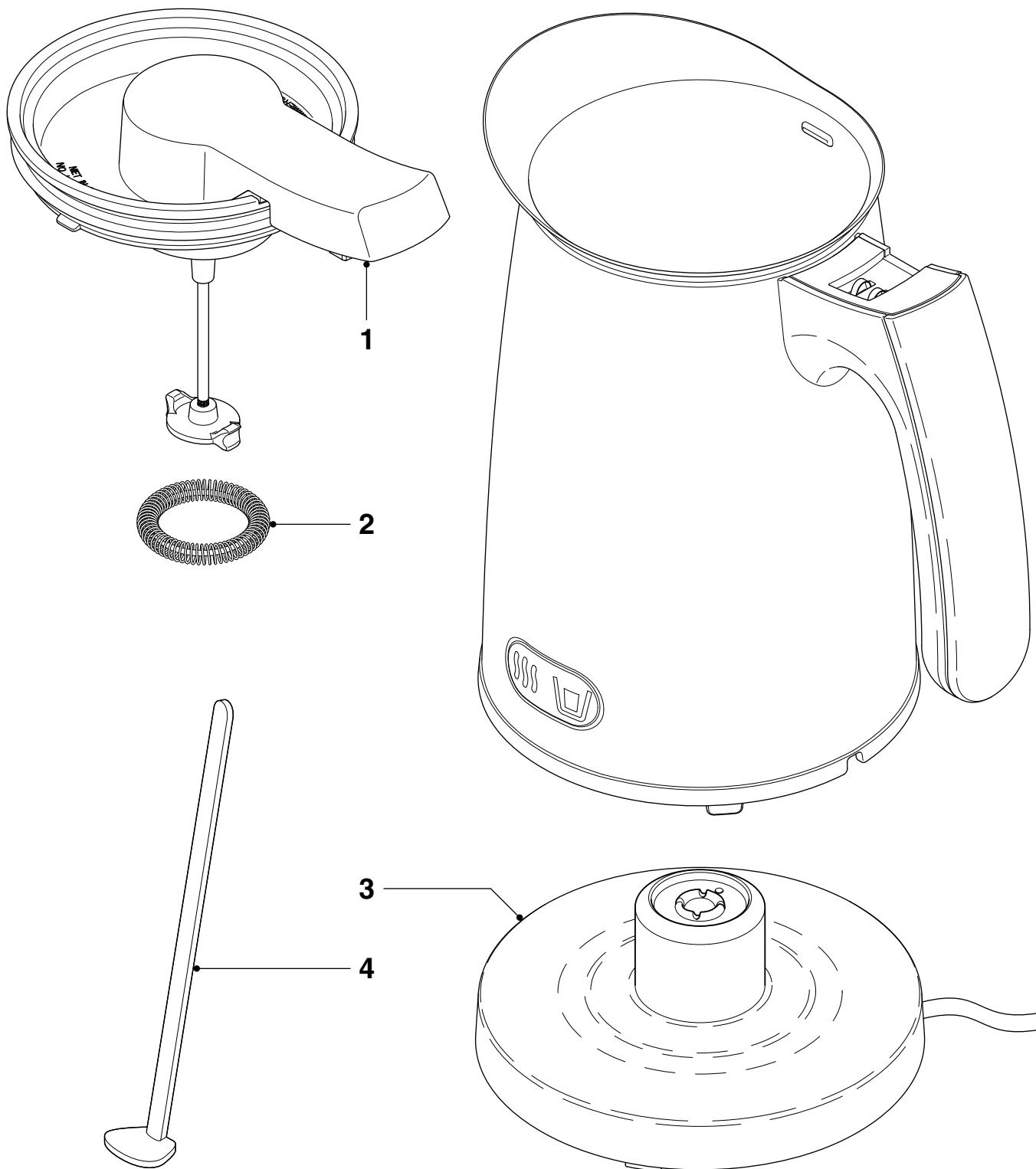

| Pos | Service code   | Description   |
|-----|----------------|---------------|
| 1   | 4222 459 54081 | Lid assy      |
| 2   | 4222 459 54091 | Whisking coil |
| 3   | 4222 459 54071 | Base          |
| 4   | 4222 459 54101 | Spoon         |